



CT-S1-76/CT-S1 Casiotone

CASIO®

Quick Start Guide

After reading this document, keep it in a safe place along with the warranty certificate. Be sure to read the "Safety Precautions" in the separate "READ THIS!" sheet, and use the product correctly.

Included Accessories

- AC adaptor
- AD-A12150LW (CT-S1-76)
- AD-E95100L (CT-S1)
- Power cord (CT-S1-76 only)
- Music Stand
- Strap Lock (CT-S1 only)
- Leaflets
- READ THIS! Sheet
- Other (Warranty, etc.)

Separately Available Accessories

You can get information about accessories that are separately available for this product from your retailer or from the CASIO website.

Please refer to the website below for more detailed operating instructions and product information, including the USER'S GUIDE, Dedicated App (CASIO MUSIC SPACE) download, Operating Precautions, etc.

CT-S1-76



<https://support.casio.com/global/en/emi/manual/CT-S1-76/>

CT-S1



<https://support.casio.com/global/en/emi/manual/CT-S1/>

Preparation

Preparing a Power Supply

Using the AC Adaptor

- Connect the AC adaptor as shown in the right illustration.
 - Make sure that you use only the AC adaptor specified for this Digital Keyboard.

Using Batteries

- Bottom of console
- Insert AA-size batteries into the battery case (CT-S1-76: 8 batteries/CT-S1: 6 batteries).
- Specify the battery type. See "Specifying the Battery Type" on the reverse side of this sheet.

Computer, smartphone, etc. (commercially available) *For the CT-S1-76, connect the power cord to the AC adaptor. Connect using a USB cable that is no more than two meters long.

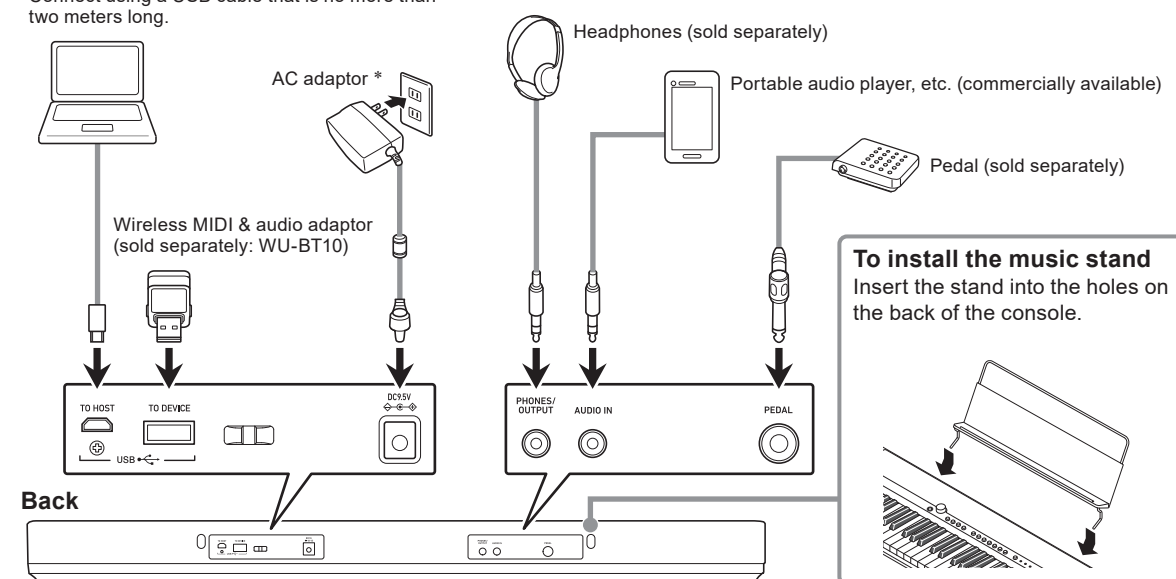

The illustration shows the CT-S1. The CT-S1 has 61 keys; the CT-S1-76 has 76 keys.

Basic Operation

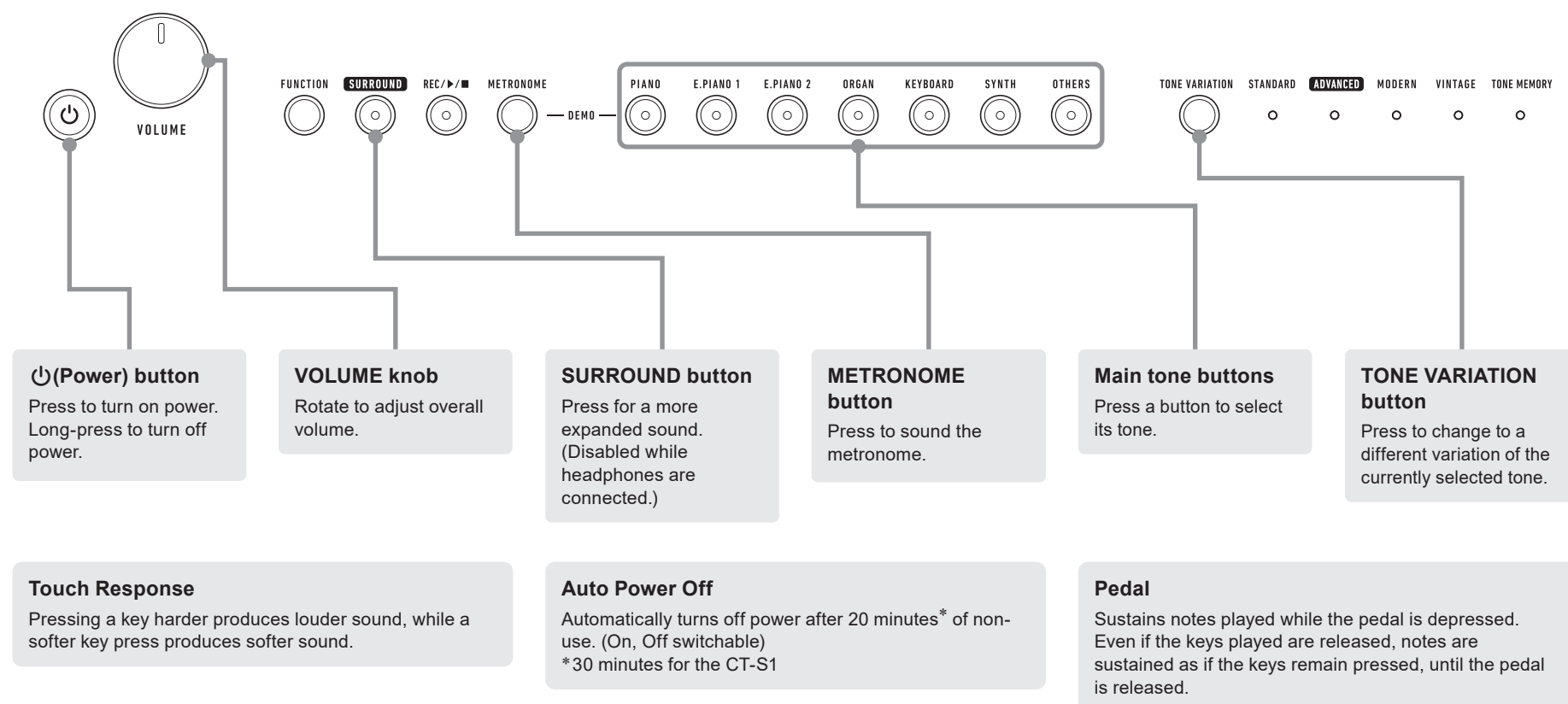

Useful Functions

For details about operations, refer to the User's Guide on the CASIO Website.

- **My Setup**
Save the current setup (tone, etc.) for later recall.
- **Reverb**
Output sounds using room, hall, and other acoustic effects.
- **Octave Shift**
Raise or lower the pitch of the keyboard in octave units.
- **Transpose**
Raise or lower the overall pitch in semitone steps.
- **Scale Tuning (Temperament)**
You can set the scale tuning of the keyboard for music that uses a scale tuning other than equal temperament.

Practicing with the Metronome

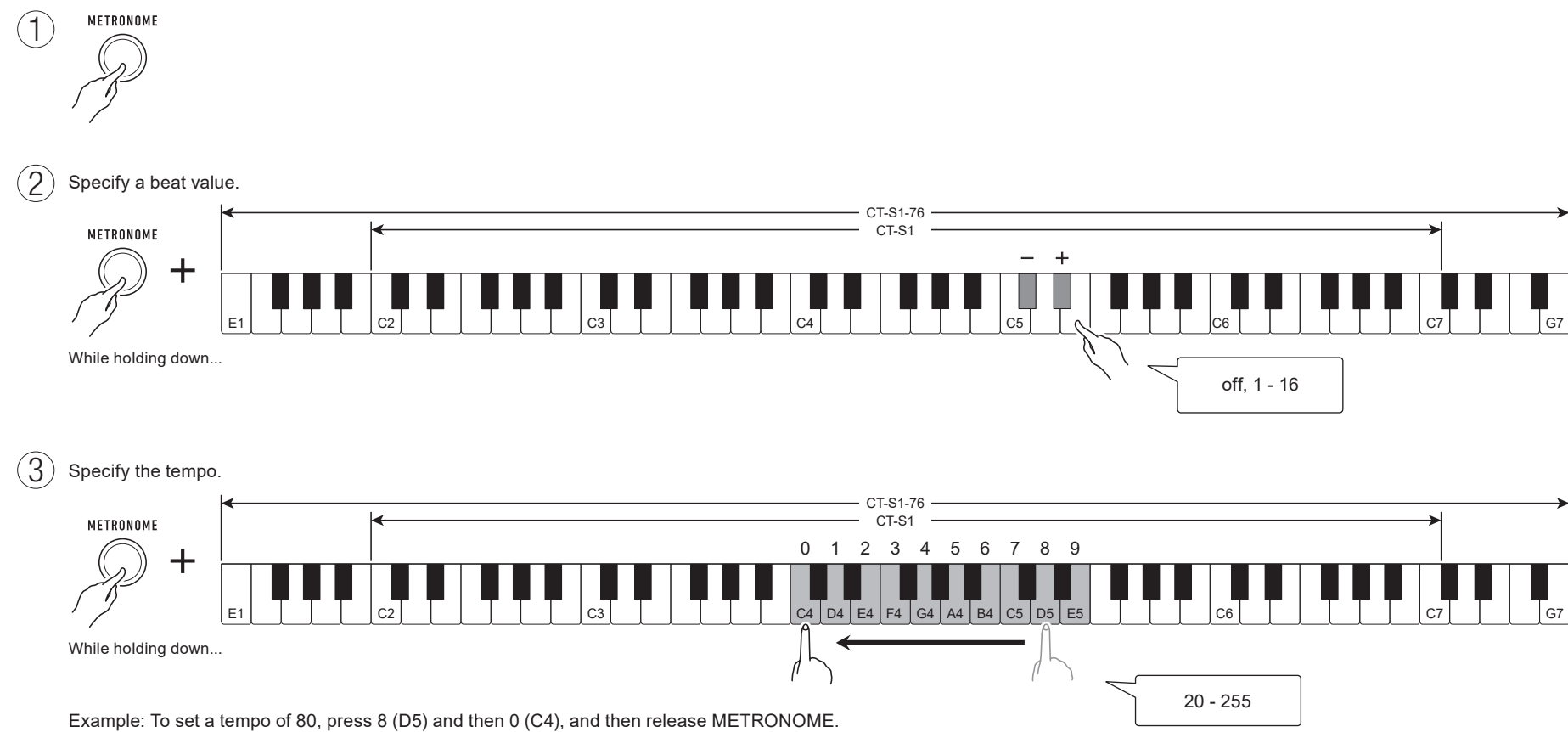

Selecting a Tone

To use the main tones to select an instrument

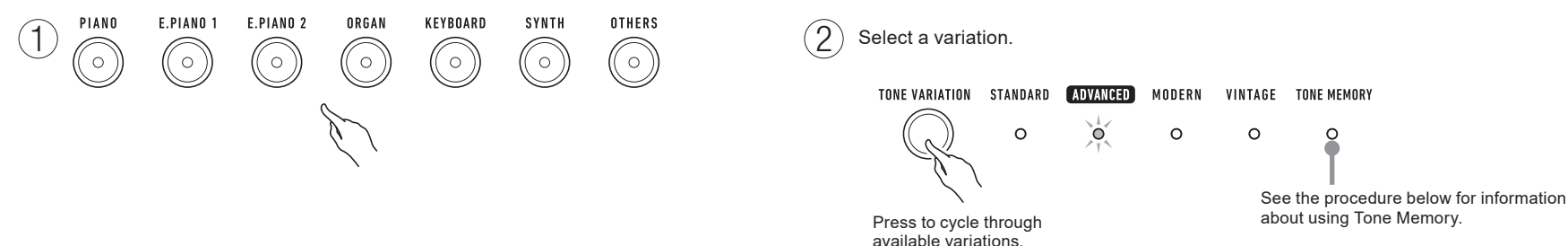

To select a tone using the keyboard keys

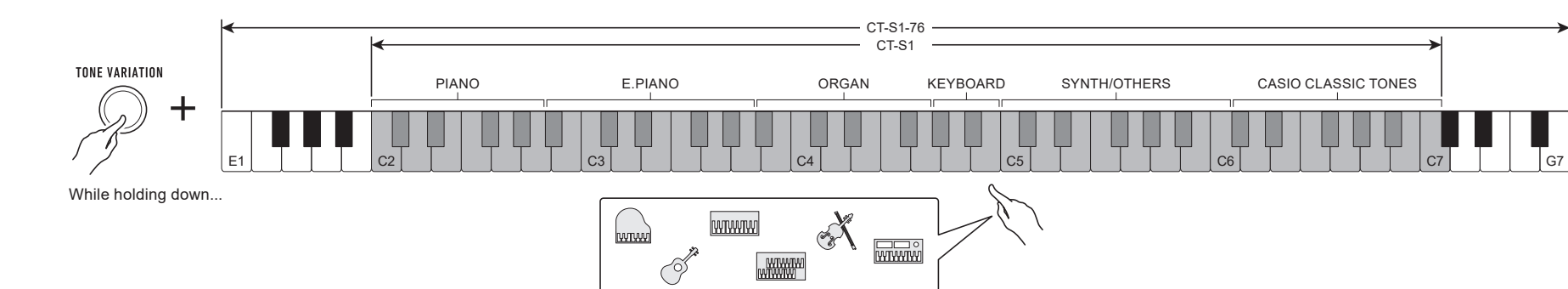

Registering the Current Main Tone Setup to a Button (Tone Memory)

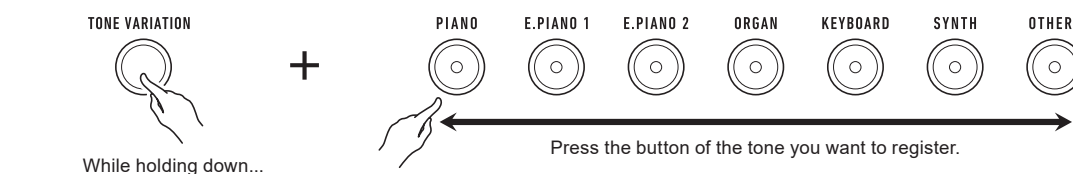

Playing with Two Layered Tones

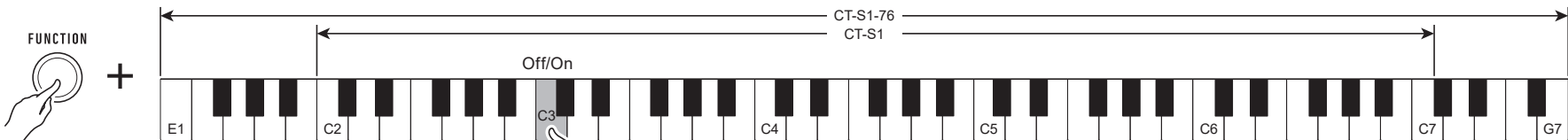
① **FUNCTION** +  While holding down... Layers the tones.

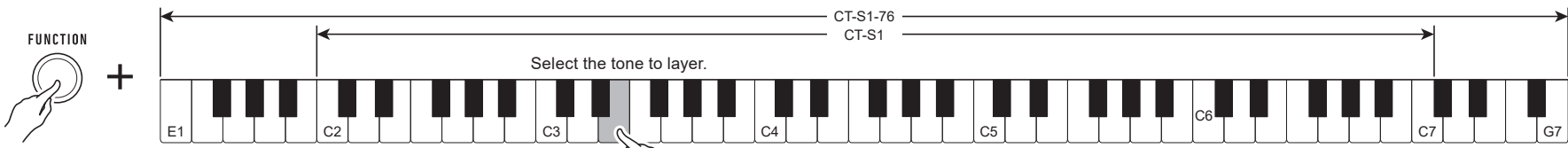
② **FUNCTION** +  While holding down... Keeping FUNCTION depressed, press the tone you want to layer.

↓

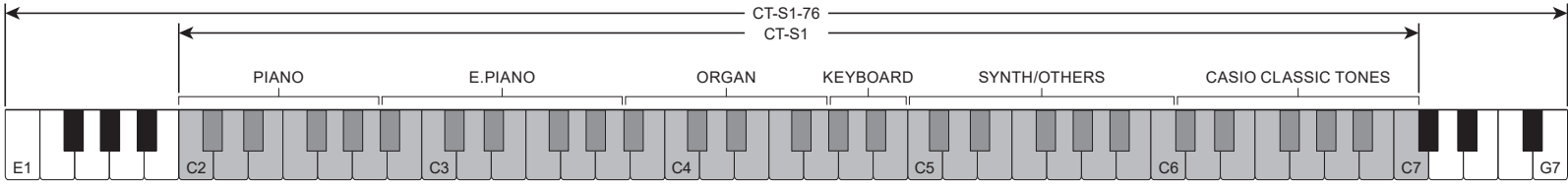
 Keeping FUNCTION depressed, press again.

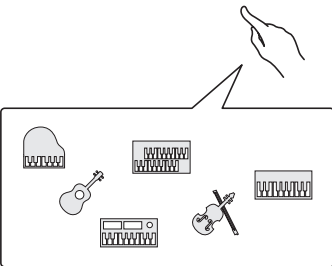

Specifying the Battery Type

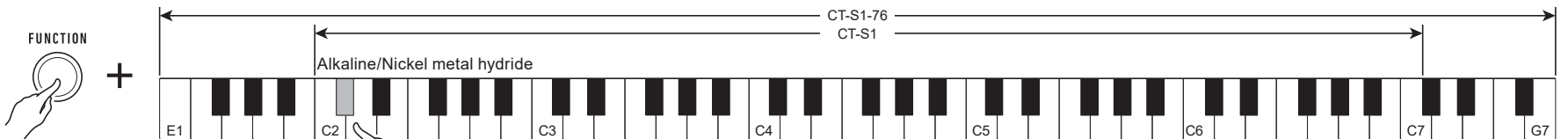
FUNCTION +  While holding down...

Returning Settings to Their Initial Factory Defaults (Initialization)

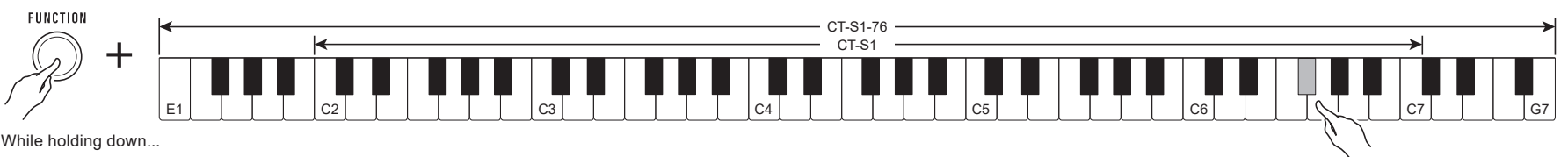
FUNCTION +  While holding down... Keeping FUNCTION depressed, press again.

↓

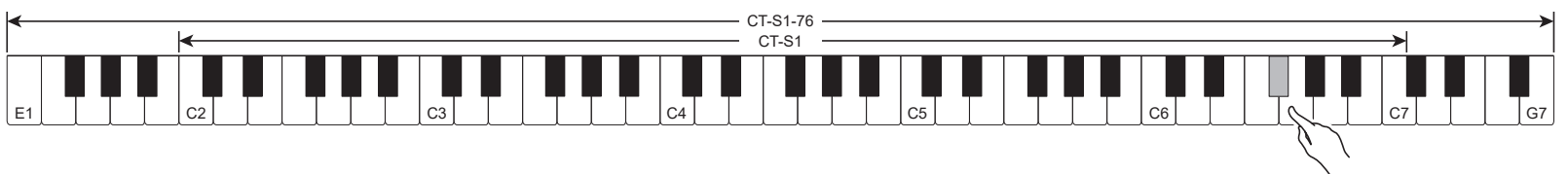
 Press again. (To execute)
This causes a re-start.

Playing with Touch Response

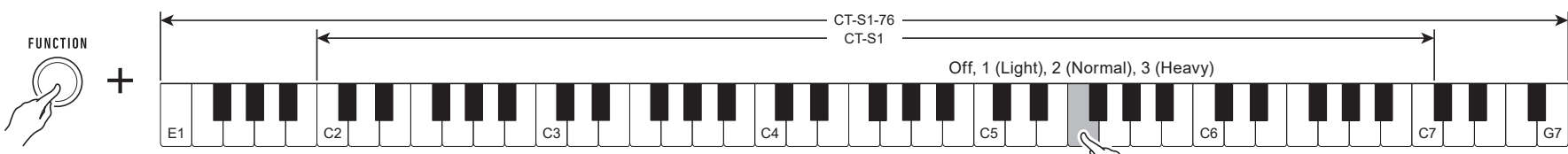

FUNCTION +  While holding down...

Off: No Touch Response.
Light: Louder notes with lighter touch than Normal.
Normal: Normal Touch Response.
Heavy: Louder notes require a heavier touch than Normal.

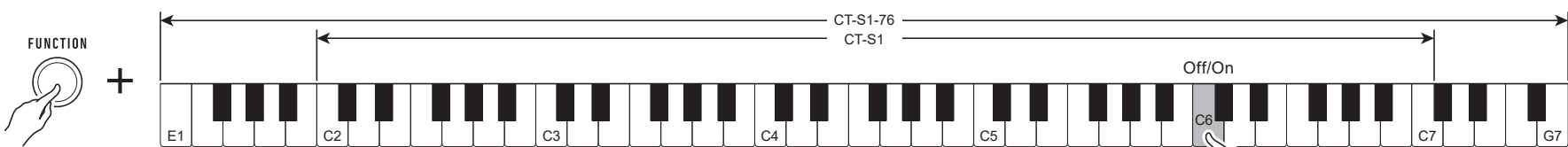
Playing with Sustain

FUNCTION +  While holding down...

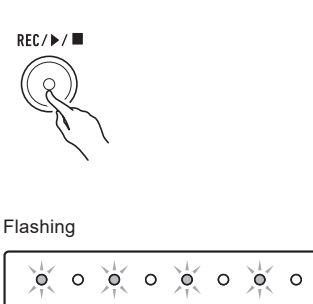
Recording Your Performance

①   This starts recording.

② Play what you want to record.

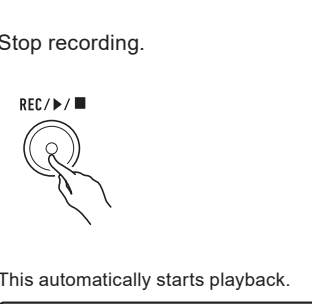
③  Stop recording. This automatically starts playback.

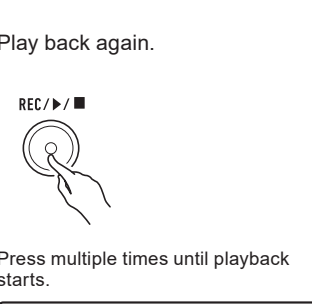
④  Play back again. Press multiple times until playback starts.

Using the Dedicated App (CASIO MUSIC SPACE)

Enjoy a range of fun functions using the Digital Keyboard together with the CASIO MUSIC SPACE app. Please visit the "Downloads" section of our website. Only the CT-S1-76 is compatible with the Remote Controller, which allows remote control of functions and settings on the Digital Keyboard via an app.

- The WU-BT10 (sold separately) or a commercially available USB cable is required to connect the Digital Keyboard to a smart device.

Reference

Product Specifications

Model: CT-S1-76BK/CT-S1-76WE
Keyboard: 76 keys
Acoustics: Amp output: 6.5W + 6.5W
Speakers: 13cm × 6cm (oval) × 2
Power Supply: 2-way power supply
Batteries: 8 AA-size alkaline batteries or AA-size rechargeable nickel metal hydride batteries
AC Adaptor: AD-A12150LW
Power consumption: 12V --- 10W
Dimensions: 114.0(W) × 25.8(D) × 8.3(H) cm (44 7/8 × 10 3/16 × 3 1/4 inch)
Weight: Approximately 5.3 kg (11.7 lbs) (Excluding batteries)

Model: CT-S1BK/CT-S1WE/CT-S1RD
Keyboard: 61 keys
Acoustics: Amp output: 2.5W + 2.5W
Speakers: 13cm × 6cm (oval) × 2
Power Supply: 2-way power supply
Batteries: 6 AA-size alkaline batteries or AA-size rechargeable nickel metal hydride batteries
AC Adaptor: AD-E95100L
Power consumption: 9.5V --- 7.5W
Dimensions: 93.0(W) × 25.8(D) × 8.3(H) cm (36 5/8 × 10 3/16 × 3 1/4 inch)
Weight: Approximately 4.5 kg (9.9 lbs) (Excluding batteries)

Specifications and designs are subject to change without notice.

- Any reproduction of the contents of this manual, either in part or its entirety, is prohibited. Except for your own, personal use, any other use of the contents of this manual without the consent of CASIO is prohibited under copyright laws.
- IN NO EVENT SHALL CASIO BE LIABLE FOR ANY DAMAGES WHATSOEVER (INCLUDING, WITHOUT LIMITATION, DAMAGES FOR LOSS OF PROFITS, BUSINESS INTERRUPTION, LOSS OF INFORMATION) ARISING OUT OF THE USE OF OR INABILITY TO USE THIS MANUAL OR PRODUCT, EVEN IF CASIO HAS BEEN ADVISED OF THE POSSIBILITY OF SUCH DAMAGES.
- The contents of this manual are subject to change without notice.
- Company and product names used in this manual may be registered trademarks of others.

Declaration of Conformity

Model Number: CT-S1-76/CT-S1
Trade Name: CASIO COMPUTER CO., LTD.
Responsible party: CASIO AMERICA, INC.
Address: 570 MT. PLEASANT AVENUE, DOVER, NEW JERSEY 07801
Telephone number: 973-361-5400
CFR 47 §2.938 (b)(2) Attestation

As of the date of first importation or marketing of this device, the device is not produced by any entity identified on the Covered List, established pursuant to 47 CFR § 1.50002, as producing covered communications equipment. This device complies with Part 15 of the FCC Rules. Operation is subject to the following two conditions:
(1) This device may not cause harmful interference, and (2) this device must accept any interference received, including interference that may cause undesired operation.

A labels rating is affixed to the bottom of the product.

WARNING

If Auto Power Off is set to [Off], the Digital Keyboard does not automatically turn off and continues to use power.

CASIO COMPUTER CO., LTD.
6-2, Hon-machi 1-chome
Shibuya-ku, Tokyo 151-8543, Japan

Published: 2/2024
MA2402-A Printed in China
© 2024 CASIO COMPUTER CO., LTD.